

# Production Worksheet

Wilcom EmbroideryStudio - Designing



Design: **4**

Title:

Stitches: 37,875  
 Height: 4.03 in  
 Width: 4.51 in  
 Colors: 12  
 Colorway: Colorway 1  
 Zoom: 1:1

Machine format: Tajima  
 Color changes: 15  
 Stops: 16  
 Trims: 363  
 Appliqués: 0  
 Left: 64.8 mm  
 Right: 49.8 mm  
 Up: 49.2 mm  
 Down: 53.1 mm  
 EndX: 0.00 in  
 EndY: 0.00 in  
 Area: 18.17 in<sup>2</sup>  
 Max stitch: 7.5 mm  
 Min stitch: 0.0 mm  
 Max jump: 7.0 mm  
 Total thread: 540.58ft  
 Total bobbin: 169.96ft

Stop Sequence:

#	N#	Color	St.	Code	Name	Chart
1.	3		4,278	3	Red	Default
2.	7		1,780	7	Green	Default
3.	5		2,380	5	Aqua	Default
4.	4		2,250		R62 G170 B237	
5.	2		839		R89 G60 B30	
6.	16		859	16	Sand	Default
7.	9		3,453	9	White	Default
8.	11		2,004	11	Dark Red	Default
9.	8		6,835	8	Black	Default
10.	7		956	7	Green	Default
11.	4		859		R62 G170 B237	
12.	15		798	15	Pink	Default
13.	6		778	6	Dark Magenta	Default
14.	3		1,084	3	Red	Default
15.	24		880	4	Yellow	Default
16.	8		7,840	8	Black	Default

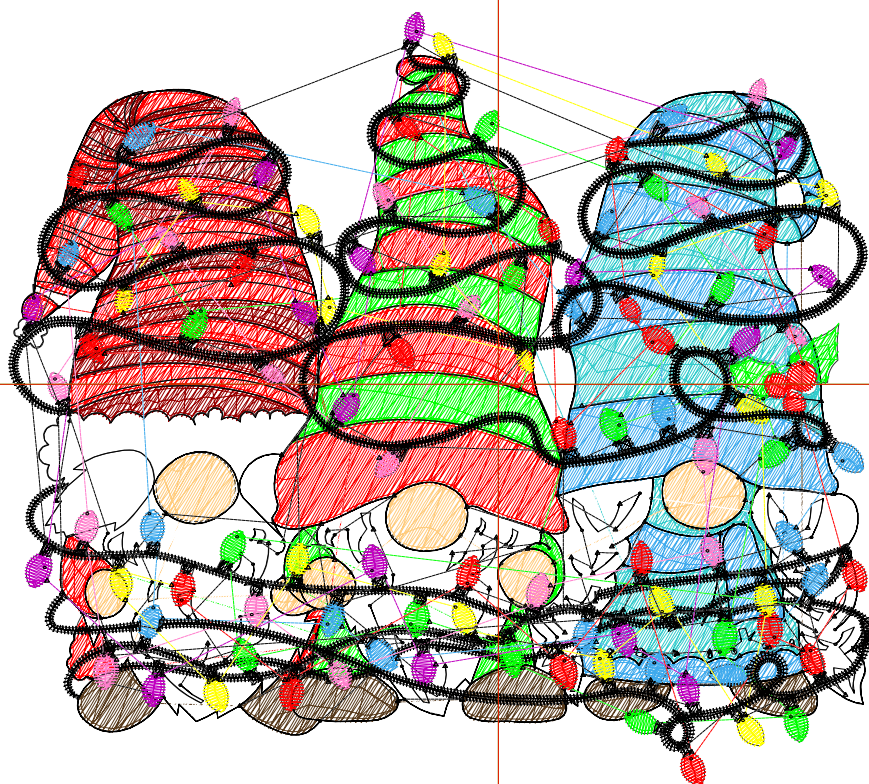

# Production Worksheet

Wilcom EmbroideryStudio - Designing



Design: **5**

Title:

Stitches: 47,104  
Height: 4.92 in  
Width: 5.51 in  
Colors: 12  
Colorway: Colorway 1  
Zoom: 1:1



# Production Worksheet

Wilcom EmbroideryStudio - Designing



Design: **5**

Title:

Stitches: 47,104  
 Height: 4.92 in  
 Width: 5.51 in  
 Colors: 12  
 Colorway: Colorway 1  
 Zoom: 1:1

Machine format: Tajima  
 Color changes: 15  
 Stops: 16  
 Trims: 382  
 Appliqués: 0  
 Left: 77.5 mm  
 Right: 62.5 mm  
 Up: 60.5 mm  
 Down: 64.4 mm  
 EndX: 0.00 in  
 EndY: 0.00 in  
 Area 27.12 in<sup>2</sup>  
 Max stitch: 10.9 mm  
 Min stitch: 0.0 mm  
 Max jump: 7.0 mm  
 Total thread: 716.04ft  
 Total bobbin: 238.05ft

Stop Sequence:

#	N#	Color	St.	Code	Name	Chart
1.	3		5,560	3	Red	Default
2.	7		2,302	7	Green	Default
3.	5		3,164	5	Aqua	Default
4.	4		2,943		R62 G170 B237	
5.	2		1,103		R89 G60 B30	
6.	16		1,123	16	Sand	Default
7.	9		4,771	9	White	Default
8.	11		2,546	11	Dark Red	Default
9.	8		7,916	8	Black	Default
10.	7		1,125	7	Green	Default
11.	4		996		R62 G170 B237	
12.	15		920	15	Pink	Default
13.	6		906	6	Dark Magenta	Default
14.	3		1,271	3	Red	Default
15.	24		1,006	4	Yellow	Default
16.	8		9,450	8	Black	Default

# Production Worksheet

Wilcom EmbroideryStudio - Designing



Design: **6**

Title:

Stitches: 56,642  
Height: 5.81 in  
Width: 6.51 in  
Colors: 12  
Colorway: Colorway 1  
Zoom: 1:1

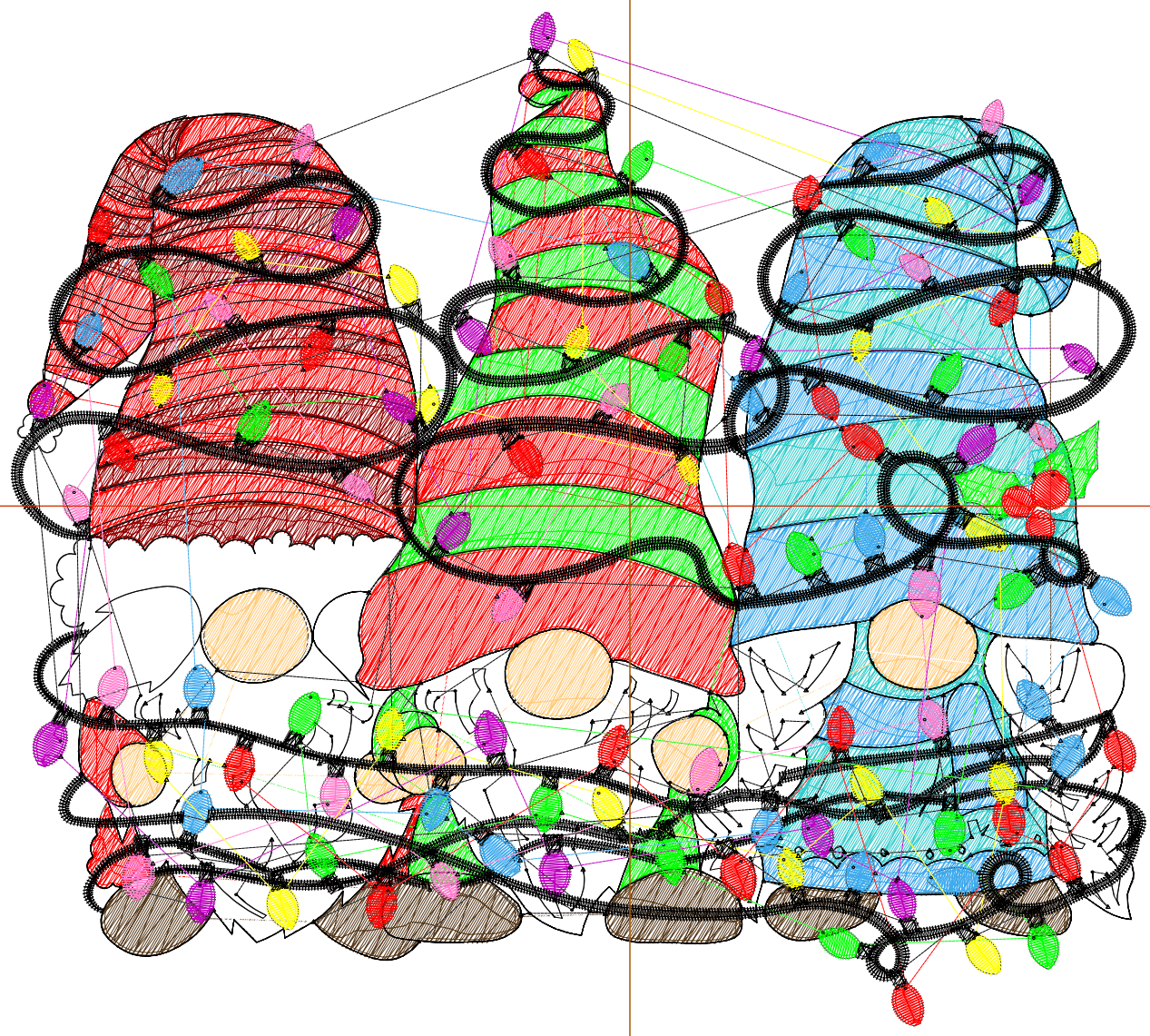

# Production Worksheet

Wilcom EmbroideryStudio - Designing



Design: **6**

Title:

Stitches: 56,642  
 Height: 5.81 in  
 Width: 6.51 in  
 Colors: 12  
 Colorway: Colorway 1  
 Zoom: 1:1

Machine format: Tajima  
 Color changes: 15  
 Stops: 16  
 Trims: 395  
 Appliqués: 0  
 Left: 90.2 mm  
 Right: 75.2 mm  
 Up: 71.9 mm  
 Down: 75.8 mm  
 EndX: 0.00 in  
 EndY: 0.00 in  
 Area 37.87 in<sup>2</sup>  
 Max stitch: 10.8 mm  
 Min stitch: 0.0 mm  
 Max jump: 7.0 mm  
 Total thread: 909.54ft  
 Total bobbin: 315.63ft

Stop Sequence:

#	N#	Color	St.	Code	Name	Chart
1.	3		6,984	3	Red	Default
2.	7		2,879	7	Green	Default
3.	5		3,930	5	Aqua	Default
4.	4		3,741		R62 G170 B237	
5.	2		1,391		R89 G60 B30	
6.	16		1,417	16	Sand	Default
7.	9		6,079	9	White	Default
8.	11		3,180	11	Dark Red	Default
9.	8		8,957	8	Black	Default
10.	7		1,325	7	Green	Default
11.	4		1,138		R62 G170 B237	
12.	15		1,048	15	Pink	Default
13.	6		1,021	6	Dark Magenta	Default
14.	3		1,465	3	Red	Default
15.	24		1,148	4	Yellow	Default
16.	8		10,937	8	Black	Default

# Production Worksheet

Wilcom EmbroideryStudio - Designing



Design: 7

Title:

Stitches: 66,959  
Height: 6.71 in  
Width: 7.51 in  
Colors: 12  
Colorway: Colorway 1  
Zoom: 1:1

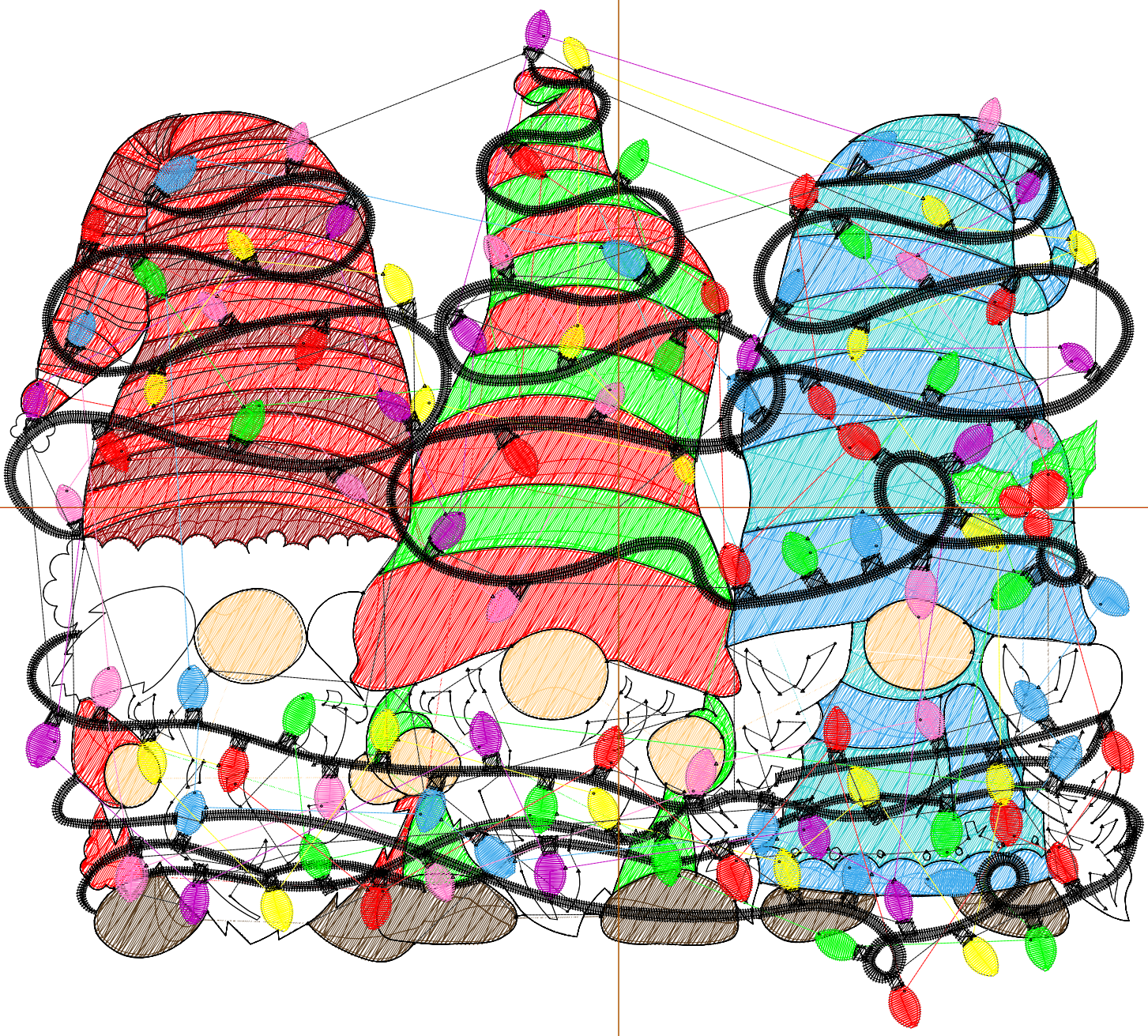

# Production Worksheet

Wilcom EmbroideryStudio - Designing



Design: **7**

Title:

Stitches: 66,959  
 Height: 6.71 in  
 Width: 7.51 in  
 Colors: 12  
 Colorway: Colorway 1  
 Zoom: 1:1

Machine format: Tajima  
 Color changes: 15  
 Stops: 16  
 Trims: 402  
 Appliqués: 0  
 Left: 102.9 mm  
 Right: 87.9 mm  
 Up: 83.3 mm  
 Down: 87.2 mm  
 EndX: 0.00 in  
 EndY: 0.00 in  
 Area 50.40 in<sup>2</sup>  
 Max stitch: 8.8 mm  
 Min stitch: 0.0 mm  
 Max jump: 7.0 mm  
 Total thread: 1128.29ft  
 Total bobbin: 405.14ft

Stop Sequence:

#	N#	Color	St.	Code	Name	Chart
1.	3		8,566	3	Red	Default
2.	7		3,528	7	Green	Default
3.	5		4,753	5	Aqua	Default
4.	4		4,622		R62 G170 B237	
5.	2		1,731		R89 G60 B30	
6.	16		1,739	16	Sand	Default
7.	9		7,724	9	White	Default
8.	11		3,781	11	Dark Red	Default
9.	8		9,969	8	Black	Default
10.	7		1,513	7	Green	Default
11.	4		1,284		R62 G170 B237	
12.	15		1,183	15	Pink	Default
13.	6		1,164	6	Dark Magenta	Default
14.	3		1,674	3	Red	Default
15.	24		1,289	4	Yellow	Default
16.	8		12,437	8	Black	Default