

Production Worksheet

Wilcom EmbroideryStudio - Designing



Design: **3**

Title:

Stitches: 12,541
 Height: 2.70 in
 Width: 3.51 in
 Colors: 10
 Colorway: Colorway 1
 Zoom: 1:1

Machine format: Tajima
 Color changes: 9
 Stops: 10
 Trims: 112
 Appliqués: 0
 Left: 46.1 mm
 Right: 43.1 mm
 Up: 34.9 mm
 Down: 33.8 mm
 EndX: 0.00 in
 EndY: 0.00 in
 Area 9.50 in²
 Max stitch: 11.1 mm
 Min stitch: 0.1 mm
 Max jump: 7.0 mm
 Total thread: 188.17ft
 Total bobbin: 60.80ft

Stop Sequence:

#	N#	Color	St.	Code	Name	Chart
1.	2		2,189		R125 G194 B85	
2.	1		1,762		R212 G74 B64	
3.	4		1,327	4	Yellow	Default
4.	12		904	12	Orange	Default
5.	5		1,051		R214 G177 B190	
6.	17		1,474	17	Turquoise	Default
7.	3		1,013		R86 G166 B140	
8.	15		643	15	Pink	Default
9.	6		819		R9 G51 B8	
10.	8		1,357	8	Black	Default

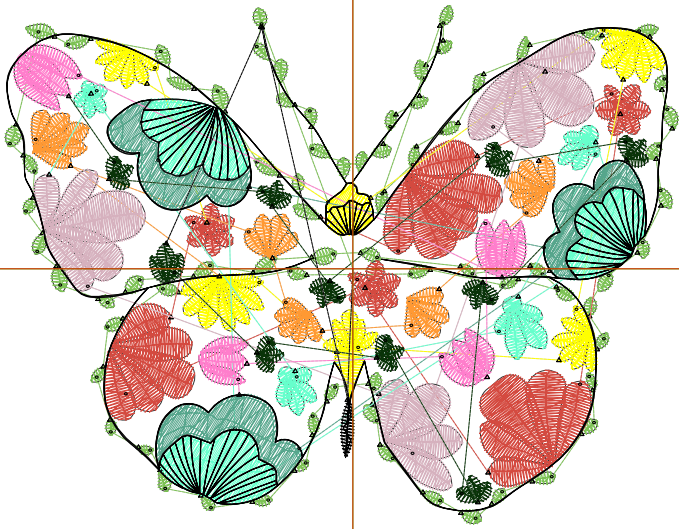

Production Worksheet

Wilcom EmbroideryStudio - Designing



Design: **4**

Title:

Stitches: 16,213
 Height: 3.48 in
 Width: 4.51 in
 Colors: 10
 Colorway: Colorway 1
 Zoom: 1:1

Machine format: Tajima
 Color changes: 9
 Stops: 10
 Trims: 120
 Appliqués: 0
 Left: 58.8 mm
 Right: 55.8 mm
 Up: 44.7 mm
 Down: 43.6 mm
 EndX: 0.00 in
 EndY: 0.00 in
 Area: 15.68 in²
 Max stitch: 11.0 mm
 Min stitch: 0.1 mm
 Max jump: 6.9 mm
 Total thread: 269.53ft
 Total bobbin: 94.73ft

Stop Sequence:

#	N#	Color	St.	Code	Name	Chart
1.	2		2,585		R125 G194 B85	
2.	1		2,352		R212 G74 B64	
3.	4		1,717	4	Yellow	Default
4.	12		1,136	12	Orange	Default
5.	5		1,526		R214 G177 B190	
6.	17		2,027	17	Turquoise	Default
7.	3		1,379		R86 G166 B140	
8.	15		853	15	Pink	Default
9.	6		1,025		R9 G51 B8	
10.	8		1,611	8	Black	Default

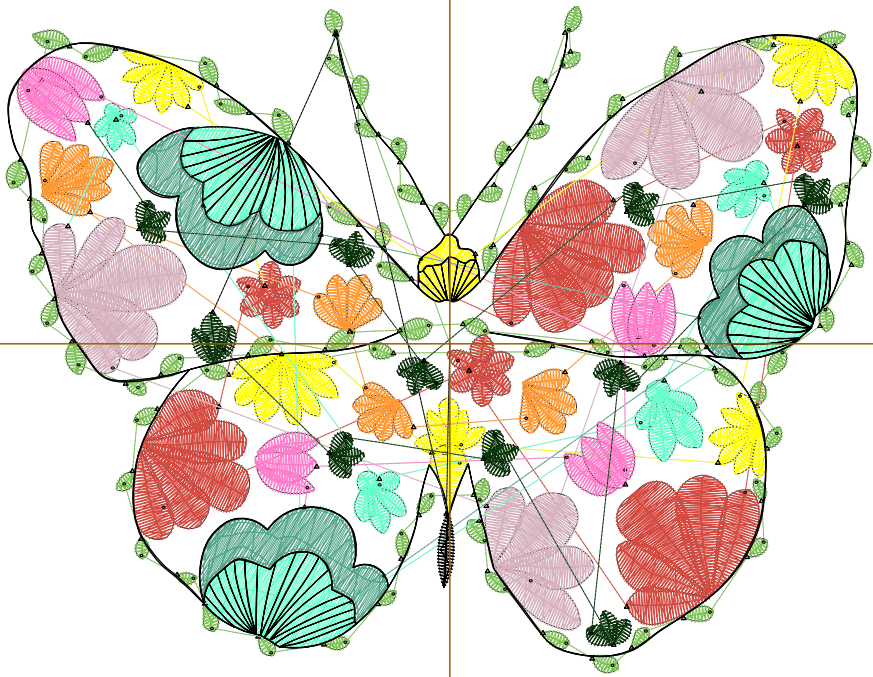

Production Worksheet

Wilcom EmbroideryStudio - Designing



Design: **5**

Title:

Stitches: 20,416
Height: 4.25 in
Width: 5.51 in
Colors: 10
Colorway: Colorway 1
Zoom: 1:1

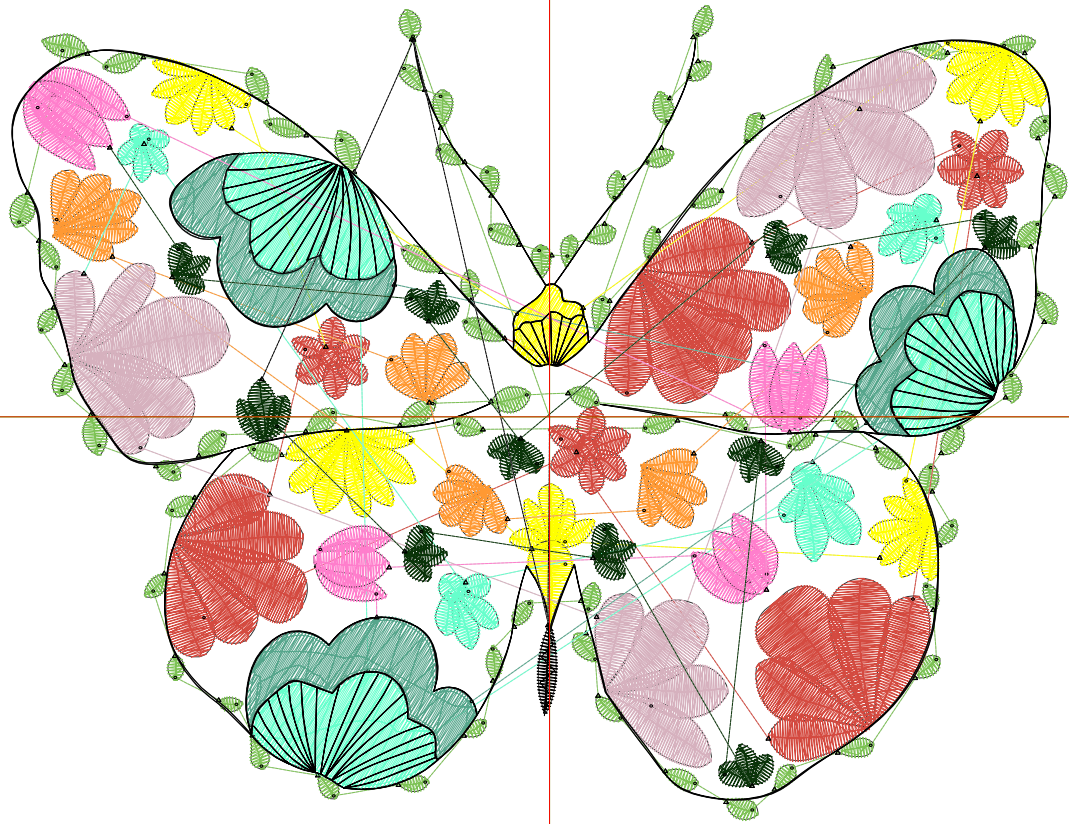

Production Worksheet

Wilcom EmbroideryStudio - Designing



Design: **5**

Title:

Stitches: 20,416
 Height: 4.25 in
 Width: 5.51 in
 Colors: 10
 Colorway: Colorway 1
 Zoom: 1:1

Machine format: Tajima
 Color changes: 9
 Stops: 10
 Trims: 124
 Appliqués: 0
 Left: 71.5 mm
 Right: 68.5 mm
 Up: 54.4 mm
 Down: 53.4 mm
 EndX: 0.00 in
 EndY: 0.00 in
 Area 23.40 in²
 Max stitch: 10.4 mm
 Min stitch: 0.1 mm
 Max jump: 7.0 mm
 Total thread: 368.34ft
 Total bobbin: 136.95ft

Stop Sequence:

#	N#	Color	St.	Code	Name	Chart
1.	2		2,981		R125 G194 B85	
2.	1		3,231		R212 G74 B64	
3.	4		2,100	4	Yellow	Default
4.	12		1,382	12	Orange	Default
5.	5		2,149		R214 G177 B190	
6.	17		2,619	17	Turquoise	Default
7.	3		1,791		R86 G166 B140	
8.	15		1,078	15	Pink	Default
9.	6		1,217		R9 G51 B8	
10.	8		1,866	8	Black	Default

Production Worksheet

Wilcom EmbroideryStudio - Designing



Design: **6**

Title:

Stitches: 25,291
Height: 5.02 in
Width: 6.51 in
Colors: 10
Colorway: Colorway 1
Zoom: 1:1

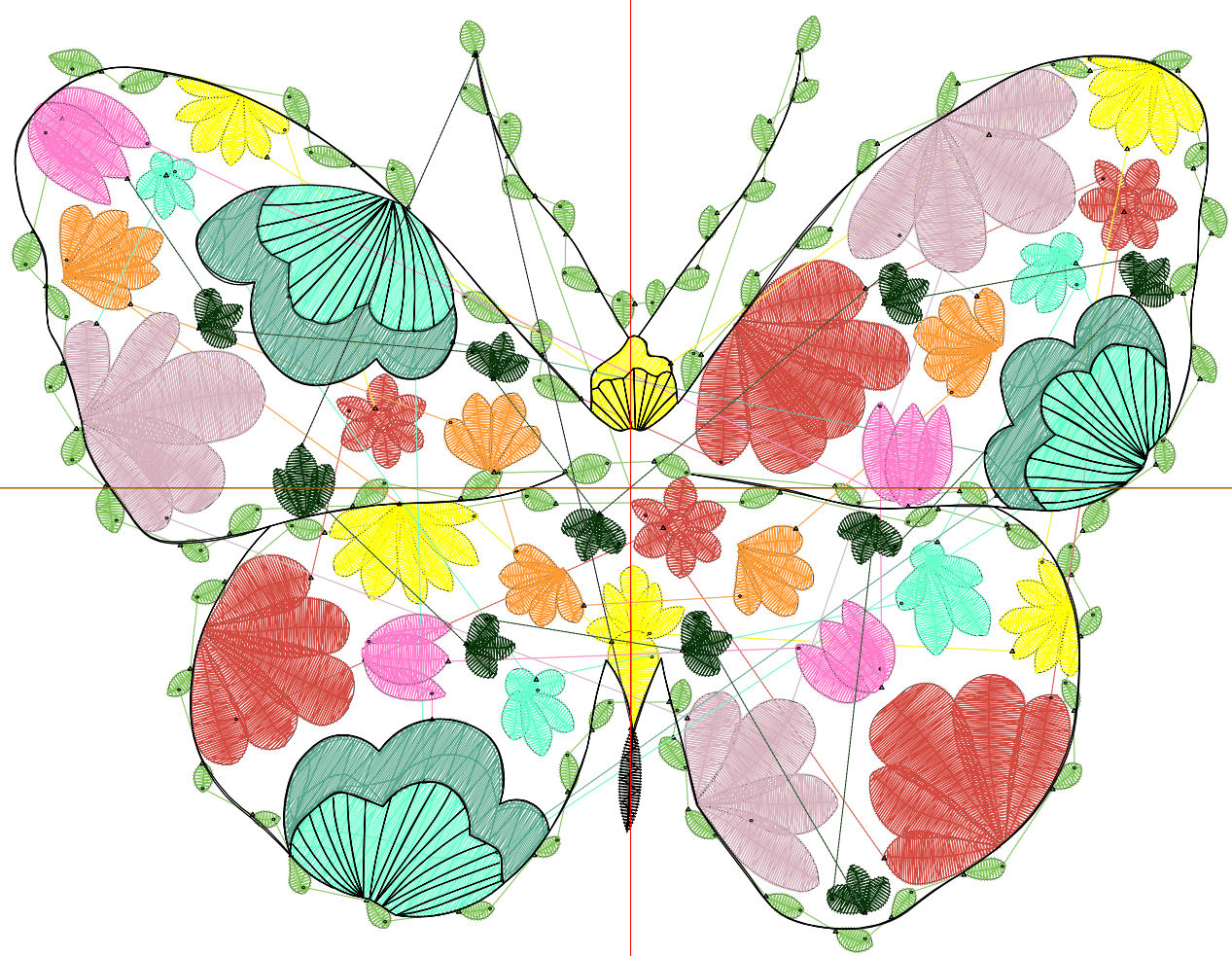

Production Worksheet

Wilcom EmbroideryStudio - Designing



Design: **6**

Title:

Stitches: 25,291
 Height: 5.02 in
 Width: 6.51 in
 Colors: 10
 Colorway: Colorway 1
 Zoom: 1:1

Machine format: Tajima
 Color changes: 9
 Stops: 10
 Trims: 124
 Appliqués: 0
 Left: 84.2 mm
 Right: 81.2 mm
 Up: 64.2 mm
 Down: 63.2 mm
 EndX: 0.00 in
 EndY: 0.00 in
 Area 32.67 in²
 Max stitch: 10.5 mm
 Min stitch: 0.0 mm
 Max jump: 6.9 mm
 Total thread: 485.98ft
 Total bobbin: 187.70ft

Stop Sequence:

#	N#	Color	St.	Code	Name	Chart
1.	2		3,422		R125 G194 B85	
2.	1		4,320		R212 G74 B64	
3.	4		2,523	4	Yellow	Default
4.	12		1,633	12	Orange	Default
5.	5		2,935		R214 G177 B190	
6.	17		3,288	17	Turquoise	Default
7.	3		2,264		R86 G166 B140	
8.	15		1,348	15	Pink	Default
9.	6		1,433		R9 G51 B8	
10.	8		2,123	8	Black	Default

Production Worksheet

Wilcom EmbroideryStudio - Designing



Design: **7**

Title:

Stitches: 30,500
Height: 5.79 in
Width: 7.51 in
Colors: 10
Colorway: Colorway 1
Zoom: 1:1

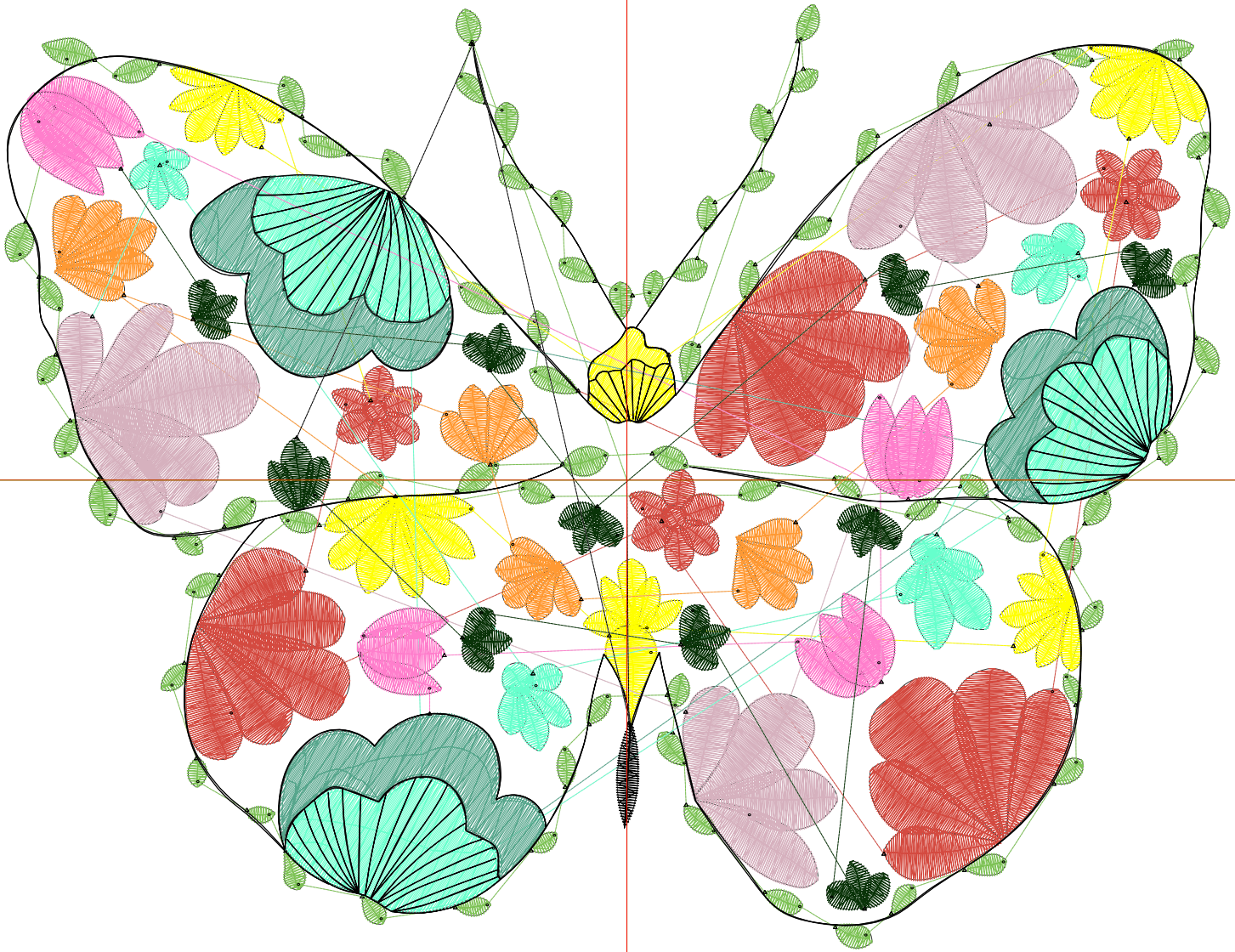

Production Worksheet

Wilcom EmbroideryStudio - Designing



Design: **7**

Title:

Stitches: 30,500
 Height: 5.79 in
 Width: 7.51 in
 Colors: 10
 Colorway: Colorway 1
 Zoom: 1:1

Machine format: Tajima
 Color changes: 9
 Stops: 10
 Trims: 124
 Appliqués: 0
 Left: 96.9 mm
 Right: 93.9 mm
 Up: 74.0 mm
 Down: 73.0 mm
 EndX: 0.00 in
 EndY: 0.00 in
 Area 43.47 in²
 Max stitch: 12.1 mm
 Min stitch: 0.0 mm
 Max jump: 7.0 mm
 Total thread: 619.53ft
 Total bobbin: 246.59ft

Stop Sequence:

#	N#	Color	St.	Code	Name	Chart
1.	2		3,878		R125 G194 B85	
2.	1		5,347		R212 G74 B64	
3.	4		2,971	4	Yellow	Default
4.	12		1,919	12	Orange	Default
5.	5		3,755		R214 G177 B190	
6.	17		4,037	17	Turquoise	Default
7.	3		2,803		R86 G166 B140	
8.	15		1,712	15	Pink	Default
9.	6		1,693		R9 G51 B8	
10.	8		2,383	8	Black	Default