

Production Worksheet

Wilcom EmbroideryStudio - Designing



Design: **3**

Title:

Stitches: 6,008
 Height: 2.15 in
 Width: 3.51 in
 Colors: 5
 Colorway: Colorway 1
 Zoom: 1:1

Machine format: Tajima
 Color changes: 4
 Stops: 5
 Trims: 17
 Appliqués: 0
 Left: 43.3 mm
 Right: 46.0 mm
 Up: 25.7 mm
 Down: 28.9 mm
 EndX: 0.00 in
 EndY: 0.00 in
 Area 7.55 in²
 Max stitch: 6.8 mm
 Min stitch: 0.2 mm
 Max jump: 6.9 mm
 Total thread: 100.32ft
 Total bobbin: 35.12ft

Stop Sequence:

#	N#	Color	St.	Code	Name	Chart
1.	1		1,284		R129 G139 B145	
2.	2		977		R255 G201 B37	
3.	5		979		R123 G224 B221	
4.	4		970		R106 G255 B146	
5.	3		1,796		R255 G179 B231	

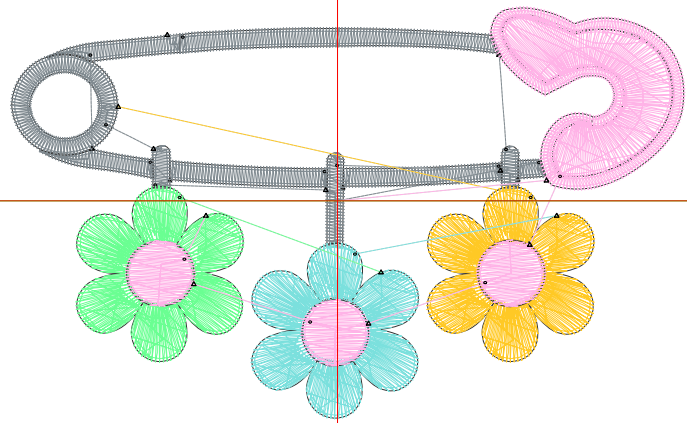

Production Worksheet

Wilcom EmbroideryStudio - Designing



Design: **4**

Title:

Stitches: 8,204
Height: 2.76 in
Width: 4.51 in
Colors: 5
Colorway: Colorway 1
Zoom: 1:1

Machine format: Tajima
Color changes: 4
Stops: 5
Trims: 17
Appliqués: 0
Left: 56.0 mm
Right: 58.7 mm
Up: 33.4 mm
Down: 36.7 mm
EndX: 0.00 in
EndY: 0.00 in
Area 12.45 in²
Max stitch: 8.3 mm
Min stitch: 0.0 mm
Max jump: 6.9 mm
Total thread: 149.27ft
Total bobbin: 55.59ft

Stop Sequence:

#	N#	Color	St.	Code	Name	Chart
1.	1		1,654		R129 G139 B145	
2.	2		1,349		R255 G201 B37	
3.	5		1,341		R123 G224 B221	
4.	4		1,343		R106 G255 B146	
5.	3		2,515		R255 G179 B231	

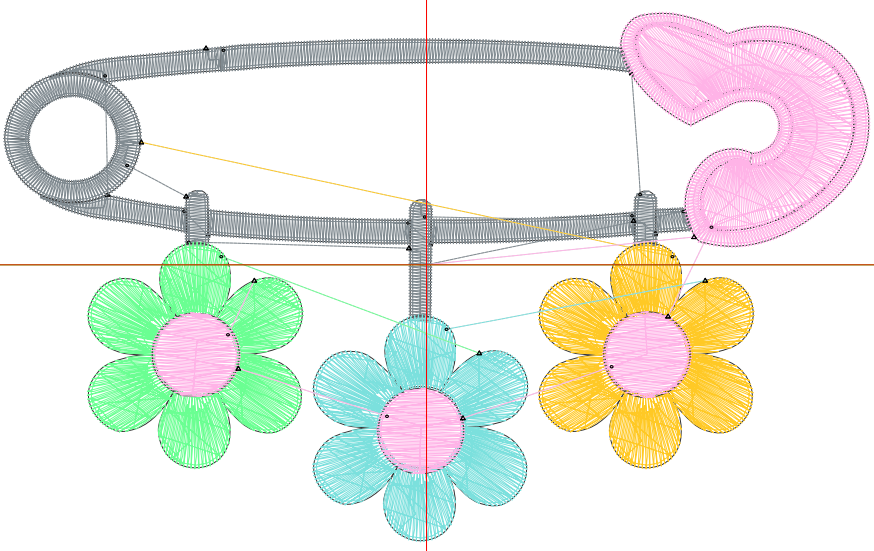

Production Worksheet

Wilcom EmbroideryStudio - Designing



Design: **5**

Title:

Stitches: 10,790
Height: 3.37 in
Width: 5.51 in
Colors: 5
Colorway: Colorway 1
Zoom: 1:1

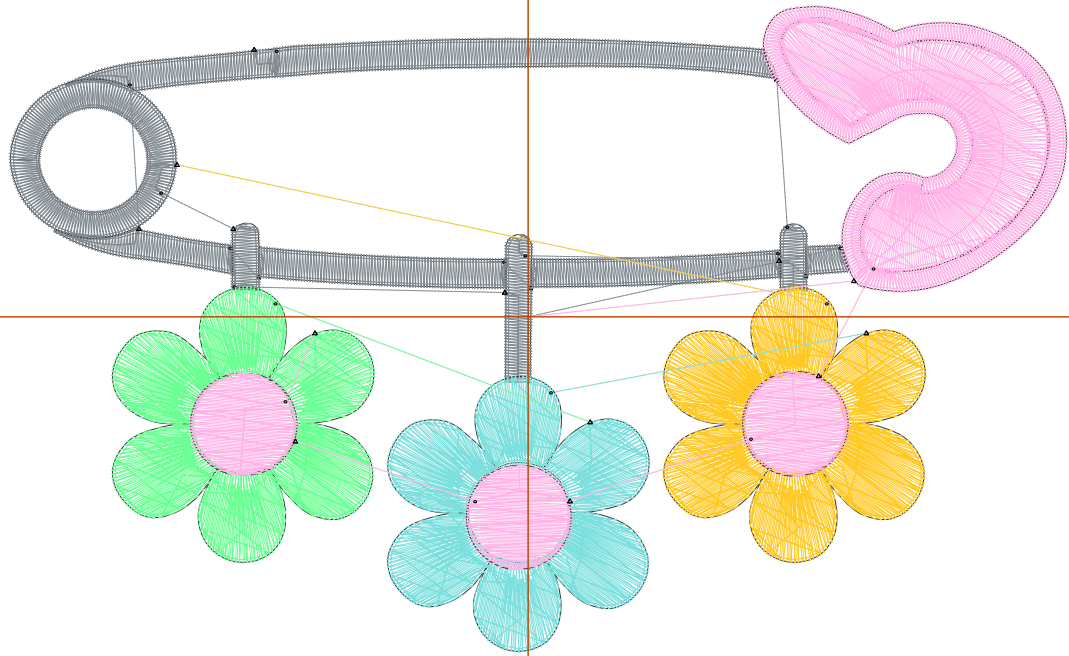

1

1

2

2

Production Worksheet

Wilcom EmbroideryStudio - Designing



Design: **5**

Title:

Stitches: 10,790
 Height: 3.37 in
 Width: 5.51 in
 Colors: 5
 Colorway: Colorway 1
 Zoom: 1:1

Machine format: Tajima
 Color changes: 4
 Stops: 5
 Trims: 17
 Appliqués: 0
 Left: 68.7 mm
 Right: 71.4 mm
 Up: 41.2 mm
 Down: 44.4 mm
 EndX: 0.00 in
 EndY: 0.00 in
 Area 18.58 in²
 Max stitch: 10.2 mm
 Min stitch: 0.3 mm
 Max jump: 7.0 mm
 Total thread: 209.46ft
 Total bobbin: 81.20ft

Stop Sequence:

#	N#	Color	St.	Code	Name	Chart
1.	1		2,029		R129 G139 B145	
2.	2		1,829		R255 G201 B37	
3.	5		1,806		R123 G224 B221	
4.	4		1,814		R106 G255 B146	
5.	3		3,310		R255 G179 B231	

Production Worksheet

Wilcom EmbroideryStudio - Designing



Design: **6**

Title:

Stitches: 13,761
Height: 3.98 in
Width: 6.51 in
Colors: 5
Colorway: Colorway 1
Zoom: 1:1

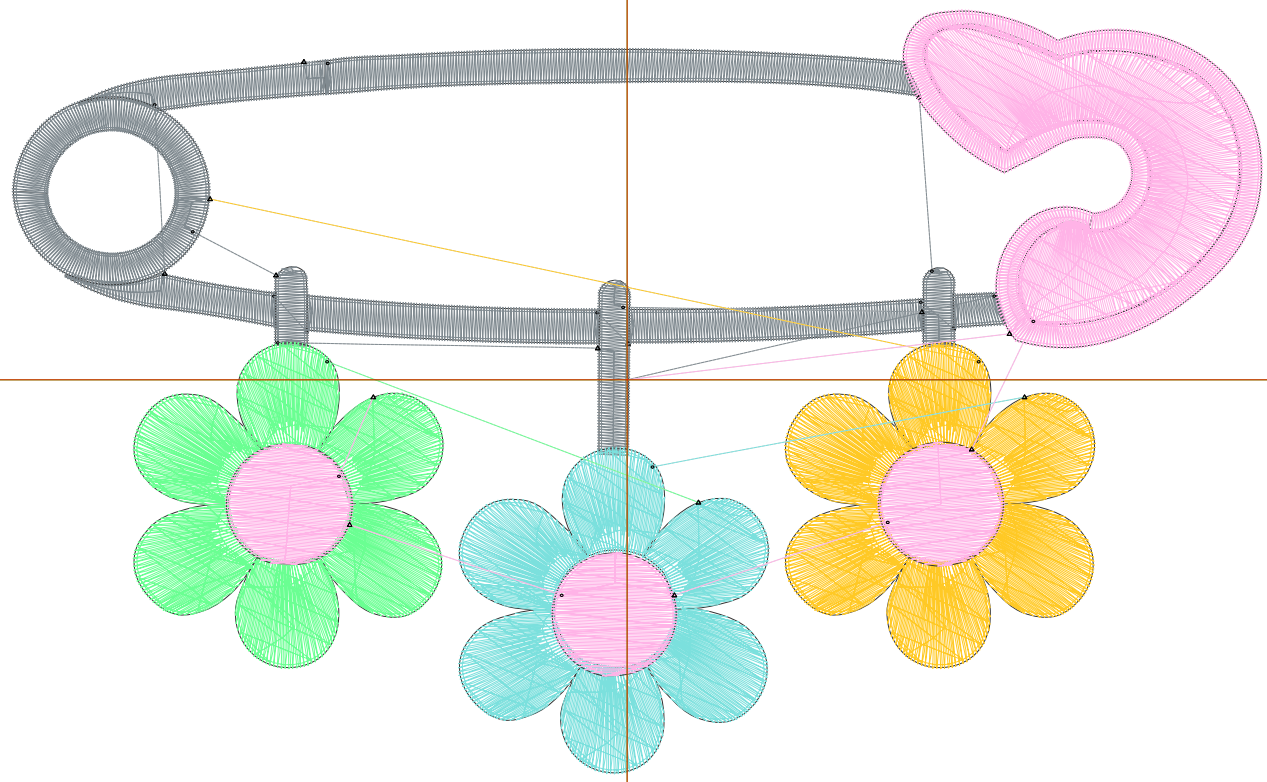

1

1

2

2

Production Worksheet

Wilcom EmbroideryStudio - Designing



Design: **6**

Title:

Stitches: 13,761
 Height: 3.98 in
 Width: 6.51 in
 Colors: 5
 Colorway: Colorway 1
 Zoom: 1:1

Machine format: Tajima
 Color changes: 4
 Stops: 5
 Trims: 17
 Appliqués: 0
 Left: 81.4 mm
 Right: 84.1 mm
 Up: 48.9 mm
 Down: 52.2 mm
 EndX: 0.00 in
 EndY: 0.00 in
 Area 25.93 in²
 Max stitch: 11.1 mm
 Min stitch: 0.1 mm
 Max jump: 7.0 mm
 Total thread: 279.22ft
 Total bobbin: 110.98ft

Stop Sequence:

#	N#	Color	St.	Code	Name	Chart
1.	1		2,427		R129 G139 B145	
2.	2		2,378		R255 G201 B37	
3.	5		2,367		R123 G224 B221	
4.	4		2,376		R106 G255 B146	
5.	3		4,211		R255 G179 B231	

Production Worksheet

Wilcom EmbroideryStudio - Designing



Design: **7**

Title:

Stitches: 17,125
Height: 4.59 in
Width: 7.51 in
Colors: 5
Colorway: Colorway 1
Zoom: 1:1

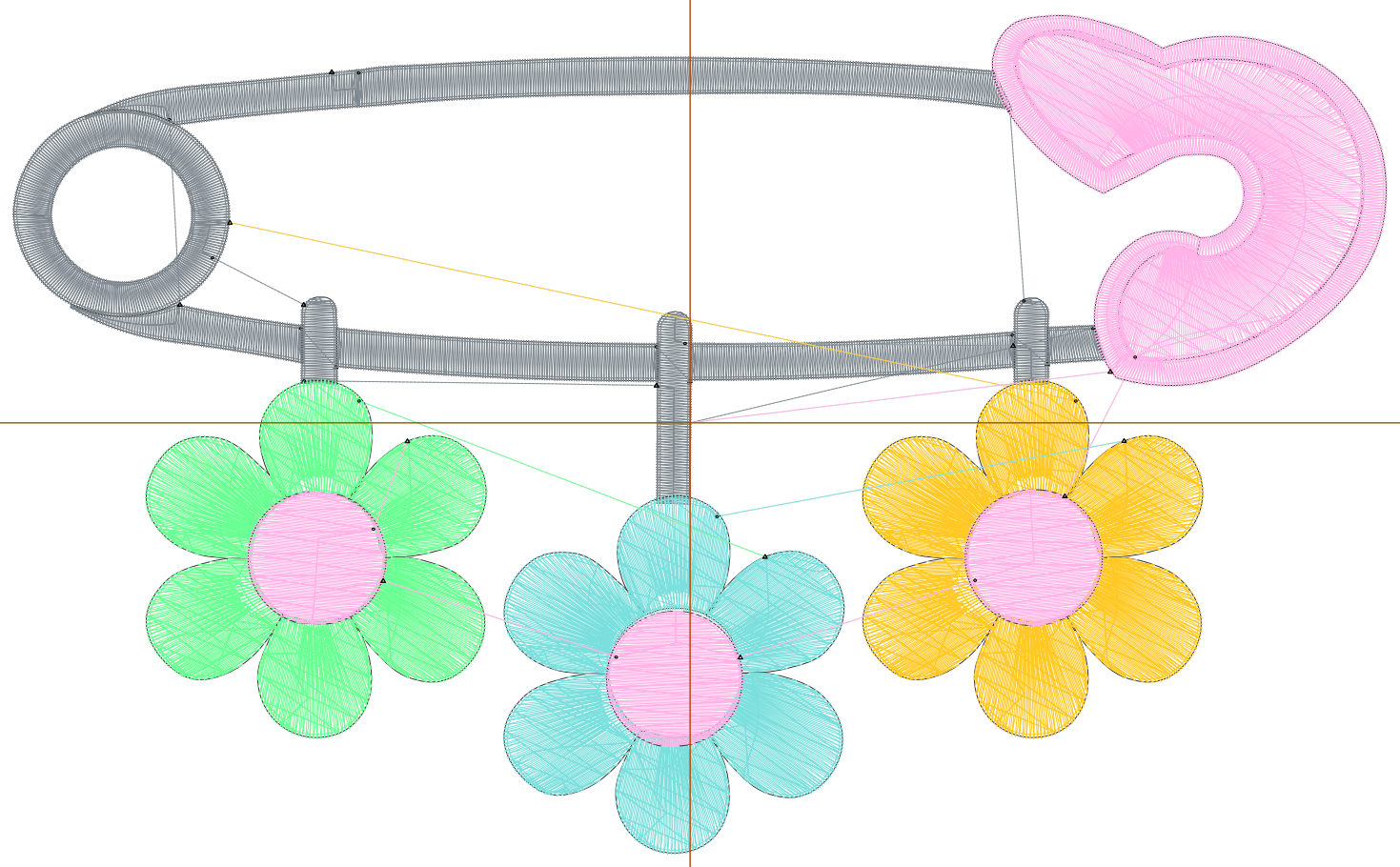

Production Worksheet

Wilcom EmbroideryStudio - Designing



Design: **7**

Title:

Stitches: 17,125
 Height: 4.59 in
 Width: 7.51 in
 Colors: 5
 Colorway: Colorway 1
 Zoom: 1:1

Machine format: Tajima
 Color changes: 4
 Stops: 5
 Trims: 17
 Appliqués: 0
 Left: 94.1 mm
 Right: 96.8 mm
 Up: 56.7 mm
 Down: 59.9 mm
 EndX: 0.00 in
 EndY: 0.00 in
 Area 34.50 in²
 Max stitch: 10.4 mm
 Min stitch: 0.3 mm
 Max jump: 7.0 mm
 Total thread: 364.47ft
 Total bobbin: 148.42ft

Stop Sequence:

#	N#	Color	St.	Code	Name	Chart
1.	1		2,881		R129 G139 B145	
2.	2		3,013		R255 G201 B37	
3.	5		2,996		R123 G224 B221	
4.	4		3,007		R106 G255 B146	
5.	3		5,226		R255 G179 B231	